

Device description

SBM52/12 Control Cabinet Bus Module for the Trox/AS-i fire protection system

Application

The Control Cabinet Bus Module SBM52/12 is used for the connection to the DDC3000-System of the AS-i Fire protection system (Fire protection flaps, smoke detector etc.) from TROX.

The DDC3000 system communicates over the RS485 interface of the SBM52/12 and the Interface converter RS485/RS232 with the AS-i Master controller MC of the fire protection system.

On one SBM52/12, a maximum of three AS-i controllers with 31 TROX fire protection components each can be connected (see connection principle).

Type

SBM52/12 Control Cabinet Bus Module with RS485 Interface for connection to the DDC3000 system of the AS-i fire protection system from TROX.

Technical data

Mains	24 V AC ±10% / 210 mA, ca. 5 VA
Bus connection	DDC Control Cabinet Bus, maximum 200 m
Interface	RS485
Fuse	electronic fuse for mains 24 V AC
Address-Switch	addressing 01..16 with 2 rotary switches
Display	2 LED in the housing for the Control Cabinet Bus LED BUSY green: blinking = Control Cabinet Bus data
Transmission	LED ERROR red: lit up = Control Cabinet Bus error blinking = incorrect address set
Degree of enclosure protection	IP20
Ambient conditions	Temperature 0..45°C Humidity 20..80% rF, not condensing
Mounting	Control cabinet installation on hat rail DIN EN 50022 – 35 x 7,5

Dimensions

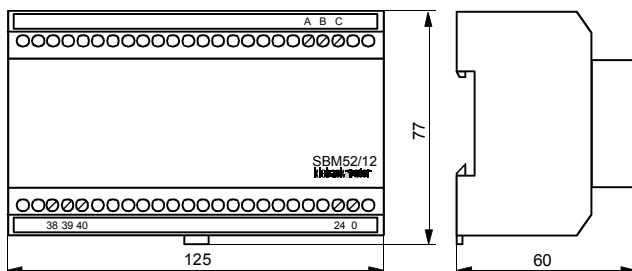

Installation



Warning

The electrical installation and the device connection may only be carried out by qualified personnel.

The VDE legal provisions and the local regulations should be observed.

- An isolated cable is required for the connection of the Control Cabinet Bus in the DDC3000 system, Cable type at least JY(St)Y 2x2x0,8 Lg. Both lines (terminals 39 and 40) must be in the form of twisted pairs. The earth connection (terminal 38) should be put on one of the remaining free lines.

At the end of the Control Cabinet Bus (most distant point from the Central Control Unit, max. 200 m), a terminating resistor ca. 180 Ω must be included on both data lines one time (terminating resistor for the Central Control Unit is included in the accessory pack).

- The connection links to the AS-i master controller MC is carried out on the interface converter PSM-ME-RS232/RS485-P with a shielded cable (line length max. 1000 m, line diameter ≥ 0,8 mm). A terminating resistor 180 Ω should be connected on the SBM52/12. The terminating resistor should be activated on the interface converter.

A maximum of three AS-i controllers can be connected to one Control Cabinet Bus Module SBM52/12 (1 Master MC and 2 Slave RC, see connection principle). For the other connections possible within the AS-i bus system, die operating instructions from TROX and IFM Electronic are determining.

Device connection

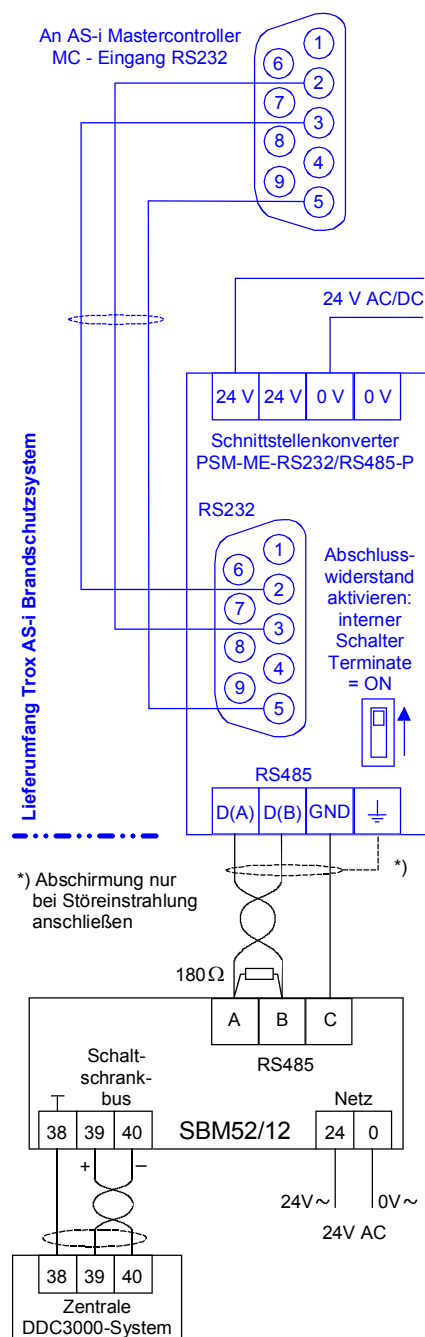

Ausgabe 02.07.2001

Mounting



Warning

Mounting and the connection of the device may only be carried out by qualified specialists.

The mains may be switched on only after the device setting by the commissioning technician/engineers has been completed.

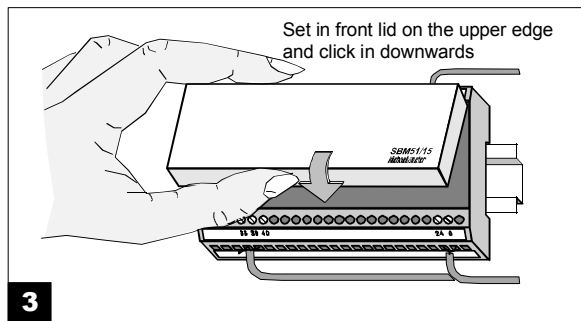
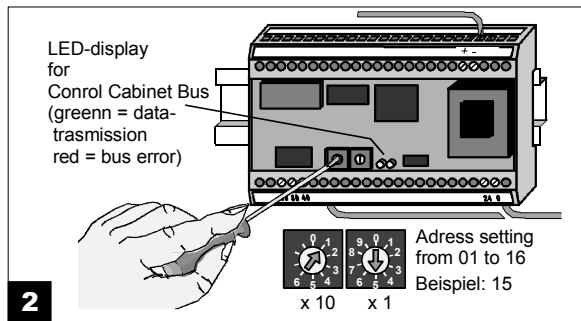
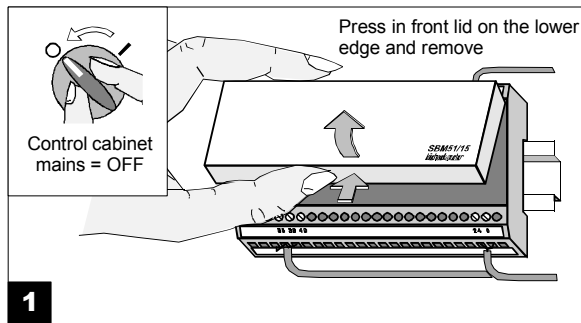
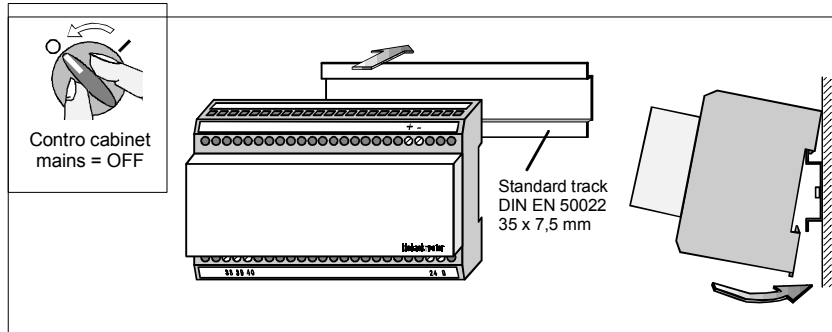

Notice

The parameterization of the Control Cabinet Bus Module SBM52/12 is described in the engineering documentation of the DDC3000.

Device description

SBM52/12 Control Cabinet Bus Module for the Trox/AS-i fire protection system

Connection principle of the bus link

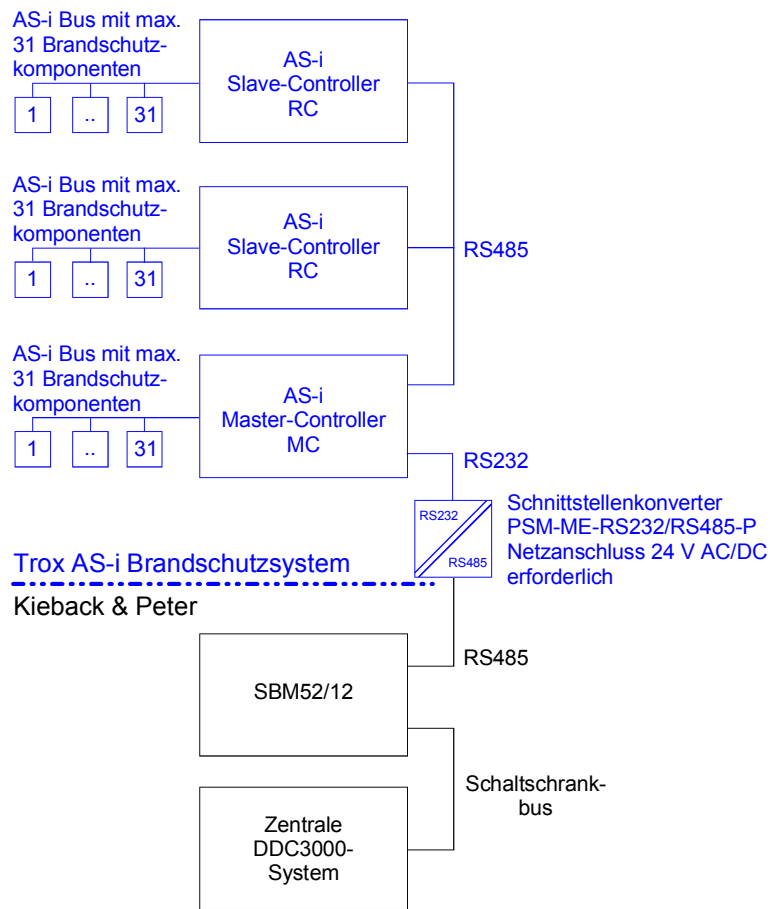

Interface converter PSM-ME-RS232/RS485-P of the AS-i Fire protection system

Notices for the commissioning technician

