

Product Description**RB15..50(-BK), RB15..50T(-BK)****RB15..50(-BK), RB15..50T(-BK) Three-way and two-way valves****Application**

The gunmetal three-way valves are used for mixing liquids precisely.

The gunmetal three-way valves of the RB15..50T series are used for mixing in drinking and service water systems and are tested and approved by DVGW.

These valves are installed as two-way valves using the BK blank cover on gate B.

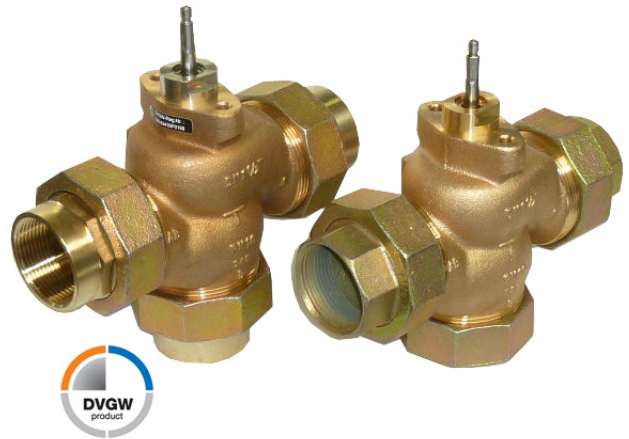

Content	Page
Important Information Regarding Product Safety	2
RB15..50 (-BK) models	3
Technical Data: RB..(-BK) Valves	4
RB15..50T (-BK) models	5
Technical Data: RB..T(-BK) Valves	6
Dimensions	7
Valve Installation	8
Valve Cross-Sections with Flow Directions	9
Overview of Compatible Valve Actuators	9

Änderungen vorbehalten - Contents subject to change - Sous réserve de modifications - Reservado el derecho a modificación - Wijzigingen voorbehouden - Con riserva di modifichie - Innehåll som skall ändras - Změny vyhrazeny - Zmiany zastrzeżone - Возможны изменения - A változtatások jogát fenntartjuk - 保留未经通知而改动的权力

Important Information Regarding Product Safety

Safety Instructions

This data sheet contains information on installing and commissioning the product "RB15..50(-BK), RB15..50T(-BK)". Each person who carries out work on this product must have read and understood this data sheet. If you have any questions that are not resolved by this data sheet, you can obtain further information from the supplier or manufacturer.

If the product is not used in accordance with this data sheet, the protection provided will be impaired.

Applicable regulations must be observed when installing and using the device. Within the EU, these include regulations regarding occupational safety and accident prevention as well as those from the VDE (Association for Electrical, Electronic & Information Technologies). If the device is used in other countries, it is the responsibility of the system installer or operator to comply with local regulations.

Mounting, installation and commissioning work on the devices may only be carried out by qualified technicians. Qualified technicians are persons who are familiar with the described product and who can assess given tasks and recognize possible dangers due to technical training, knowledge and experience as well as knowledge of the appropriate regulations.

Legend



WARNING

Indicates a hazard of medium risk which can result in death or severe bodily injury if it is not avoided.



CAUTION

Indicates a hazard of low risk which can result in minor or medium bodily injury if it is not avoided.



CAUTION

Indicates a hazard of medium risk which can result in material damage or malfunctions if it is not avoided.



NOTE

Indicates additional information that can simplify the work with the product for you.

Notes on Disposal

For disposal, the product is considered waste from electrical and electronic equipment (electronic waste) and must not be disposed of as household waste. Special treatment for specific components may be legally binding or ecologically sensible. The local and currently applicable legislation must be observed.

Product Description**RB15..50(-BK), RB15..50T(-BK)****RB15..50 (-BK) models**

Gunmetal three-way valves RB15..50 for water up to 120 °C, 16 bar

Type	DN	PN	kvs	Stroke [mm]	Connection	Weight [kg]
RB15/0,63	15	16	0.63	12	G1/2	0.9
RB15/1,0	15	16	1.0	12	G1/2	0.9
RB15/1,25	15	16	1.25	12	G1/2	0.9
RB15/1,6	15	16	1.6	12	G1/2	0.9
RB15/2,5	15	16	2.5	12	G1/2	0.9
RB15	15	16	4.0	12	G1/2	0.9
RB20/5,0	20	16	5.0	12	G3/4	1.4
RB20	20	16	6.3	12	G3/4	1.4
RB25/8,0	25	16	8.0	14	G1	1,7
RB25	25	16	10	14	G1	1.7
RB32/12,5	32	16	12.5	14	G1 1/4	3.4
RB32	32	16	16	14	G1 1/4	3.4
RB40/20	40	16	20	14	G1 1/2	4.0
RB40	40	16	25	14	G1 1/2	4.0
RB50/31,5	50	16	31.5	14	G2	5.6
RB50	50	16	40	14	G2	5.6

Gunmetal two-way valves RB15..50-BK for water up to 120 °C, 16 bar

Type	DN	PN	kvs	Stroke [mm]	Connection	Weight [kg]
RB15/0,63-BK	15	16	0.63	12	G1/2	0.9
RB15/1,0-BK	15	16	1.0	12	G1/2	0.9
RB15/1,25-BK	15	16	1.25	12	G1/2	0.9
RB15/1,6-BK	15	16	1.6	12	G1/2	0.9
RB15/2,5-BK	15	16	2.5	12	G1/2	0.9
RB15-BK	15	16	4.0	12	G1/2	0.9
RB20/5,0-BK	20	16	5.0	12	G3/4	1.4
RB20-BK	20	16	6.3	12	G3/4	1.4
RB25/8,0-BK	25	16	8.0	14	G1	1.7
RB25-BK	25	16	10	14	G1	1.7
RB32/12,5-BK	32	16	12.5	14	G1 1/4	3.4
RB32-BK	32	16	16	14	G1 1/4	3.4
RB40/20-BK	40	16	20	14	G1 1/2	4.0
RB40-BK	40	16	25	14	G1 1/2	4.0
RB50/31,5-BK	50	16	31.5	14	G2	5.6
RB50-BK	50	16	40	14	G2	5.6

RB15..50(-BK), RB15..50T(-BK)**Product Description****Technical Data: RB..(-BK) Valves**

Nominal diameter	DN15 to DN50 (G1/2 to G2)
Pressure rating	PN 16
Connection	Male thread in accordance with ISO 228/1, with female thread fittings in accordance with ISO 7/1
Characteristic curve	RB.. Gates A → AB = same percentage Gates B → AB = linear RB..-BF Gates A → AB = same percentage
Nominal stroke	RB15..20(-BK): 12 mm RB25..50(-BK): 14 mm
Leak rate	EN 1349 - seat leakage VI G 1 (leak proof)
Medium temperature	0 °C to 150 °C (max. 120 °C at 16 bar) Horizontal drive position only permissible from 130 °C and above
Housing	Gunmetal, Rg5 / CC491K
Cone	Brass CW614N
Valve spindle	CrMo steel 1.4122
Stem seal	EPDM peroxide-cured O-rings, maintenance-free
Pipe connections	Female thread fittings and GTW malleable iron union nuts, yellow chromated
Blank cover for RB..-BK	GTW malleable iron union nut, yellow chromated Steel gasket

Product Description**RB15..50(-BK), RB15..50T(-BK)****RB15..50T (-BK) models**

Gunmetal three-way valves RB15..50T for drinking and service water up to 90 °C, 16 bar

Type	DN	PN	kvs	Stroke [mm]	Connection	Weight [kg]
RB15/0,63T	15	16	0.63	12	G1/2	0.9
RB15/1,0T	15	16	1.0	12	G1/2	0.9
RB15/1,25T	15	16	1.25	12	G1/2	0.9
RB15/1,6T	15	16	1.6	12	G1/2	0.9
RB15/2,5T	15	16	2.5	12	G1/2	0.9
RB15T	15	16	4.0	12	G1/2	0.9
RB20/5,0T	20	16	5.0	12	G3/4	1.4
RB20T	20	16	6.3	12	G3/4	1.4
RB25/8,0T	25	16	8.0	14	G1	1.7
RB25T	25	16	10	14	G1	1.7
RB32/12,5T	32	16	12.5	14	G1 1/4	3.4
RB32T	32	16	16	14	G1 1/4	3.4
RB40/20T	40	16	20	14	G1 1/2	4.0
RB40T	40	16	25	14	G1 1/2	4.0
RB50/31,5T	50	16	31.5	14	G2	5.6
RB50T	50	16	40	14	G2	5.6

Gunmetal two-way valves RB15..50T-BK for drinking and service water up to 90 °C, 16 bar

Type	DN	PN	kvs	Stroke [mm]	Connection	Weight [kg]
RB15/0,63T-BK	15	16	0.63	12	G1/2	0.9
RB15/1,0T-BK	15	16	1.0	12	G1/2	0.9
RB15/1,25T-BK	15	16	1.25	12	G1/2	0.9
RB15/1,6T-BK	15	16	1.6	12	G1/2	0.9
RB15/2,5T-BK	15	16	2.5	12	G1/2	0.9
RB15T-BK	15	16	4.0	12	G1/2	0.9
RB20/5,0T-BK	20	16	5.0	12	G3/4	1.4
RB20T-BK	20	16	6.3	12	G3/4	1.4
RB25/8,0T-BK	25	16	8.0	14	G1	1.7
RB25T-BK	25	16	10	14	G1	1.7
RB32/12,5T-BK	32	16	12.5	14	G1 1/4	3.4
RB32T-BK	32	16	16	14	G1 1/4	3.4
RB40/20T-BK	40	16	20	14	G1 1/2	4.0
RB40T-BK	40	16	25	14	G1 1/2	4.0
RB50/31,5T-BK	50	16	31.5	14	G2	5.6
RB50T-BK	50	16	40	14	G2	5.6

Dimensions

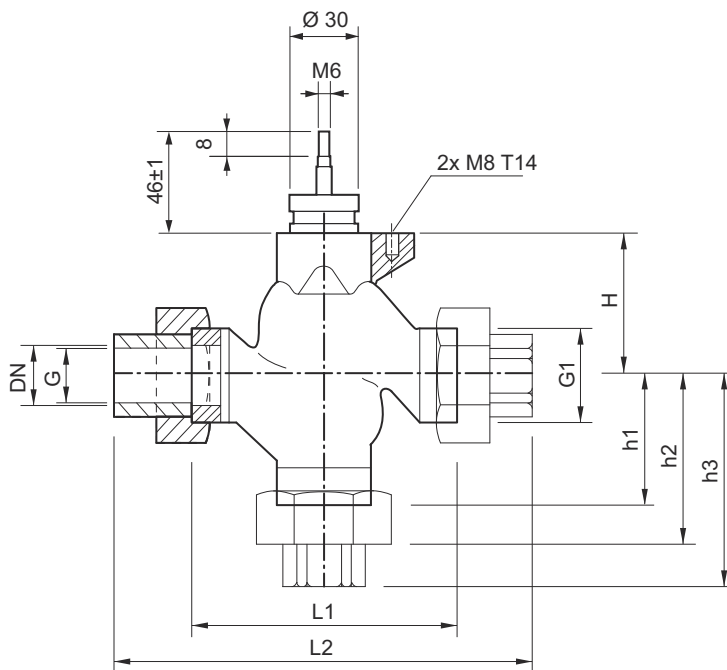

DN	L1 [mm]	L2 [mm]	h1 [mm]	h2 (RB..-BK) [mm]	h3 [mm]	H [mm]	G [Zoll]	G1 [Zoll]
15	62	114	40	48	66	40	1/2 "	1 "
20	75	127	41	53	67	43	3/4 "	1 1/4 "
25	80	138	45	57	74	46	1 "	1 1/2 "
32	120	184	55	68	89	55	1 1/4 "	2 "
40	130	198	60	73	94	58	1 1/2 "	2 1/4 "
50	150	222	65	78	101	58	2 "	2 3/4 "

Valve Installation



CAUTION

Installation and commissioning work may only be carried out by qualified technicians.

If the valve is installed in the system, make sure that no differential pressure builds up in the valve body before beginning work. If necessary, close the gate valve and turn off pumps. After the pipeline has cooled off, the actuator can be installed.

Be sure to comply with VDE guidelines and local wiring regulations. The device is connected according to the legally binding system circuit diagram.



CAUTION

The valve may only be installed by qualified technicians. In addition to the generally valid installation guidelines, the following points are to be observed:

- Any protective caps on the valve gates should be removed before assembling the valves.
- No grease or oil may be used during assembly because these could destroy the valve seals.
- The pipeline system and the interior of the fitting must be free of foreign objects, particles of dirt, and grease and oil residues. Rinse them out if necessary.
- There must be no tension between the fixture and the pipeline connection.
- To avoid eddy formations in the valve body, the valve should be installed in a straight section of the pipe. A distance of 10 times the nominal diameter is recommended between the valve flange and manifold or other similar parts.
- The installation location is to be selected so that the ambient temperature at the actuator is kept between 0 °C and +50 °C.
- A strainer should be installed upstream of the valve. For maintenance purposes, shut-off valves should be installed upstream and downstream of the valve.
- When carrying out installation, observe the maximum permitted pressure difference Δp and the specified flow direction.
- When installing the drive or removing the connection cover, ensure that there is sufficient clearance above the drive.
- Observe the flow direction arrow on the valve body. Inverting the flow direction impairs control behavior.

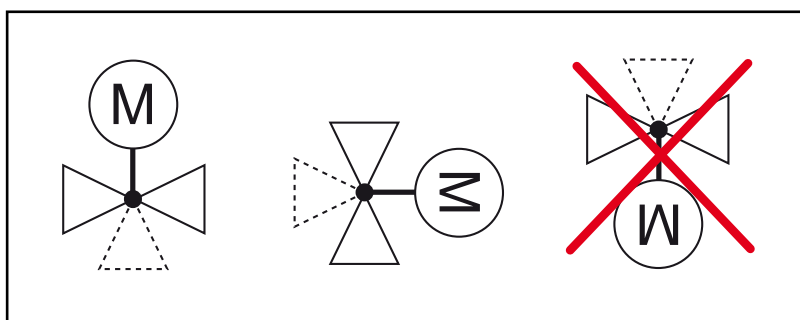

Product Description

RB15..50(-BK), RB15..50T(-BK)

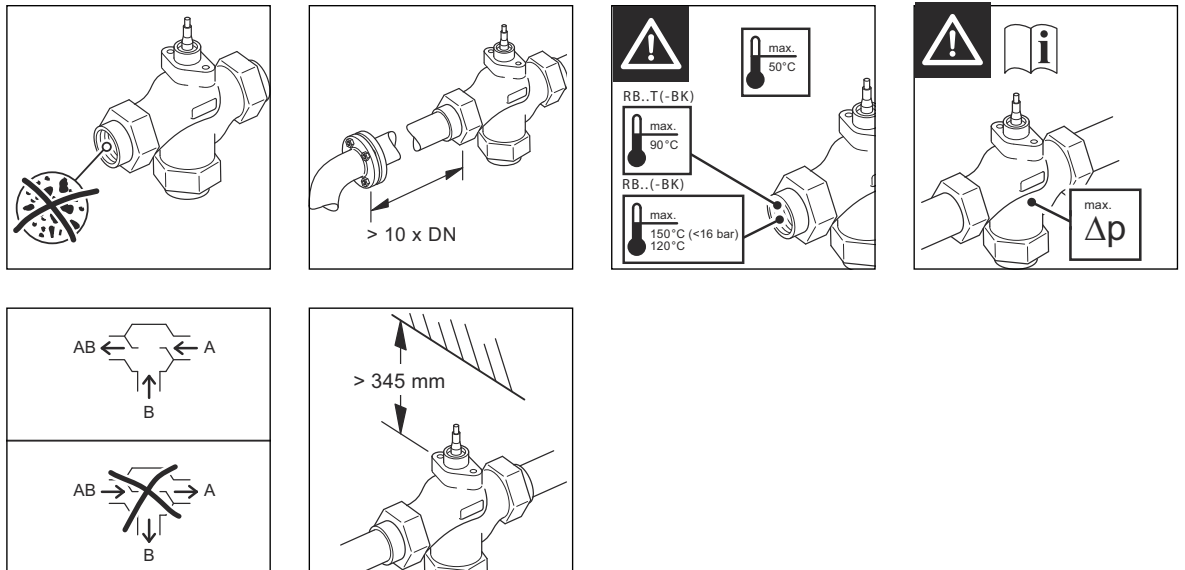

Valve Cross-Sections with Flow Directions

Two-way valve, RB15..50, RB15..50T

Three-way valve, RB15..50-BK, RB15..50T-BK

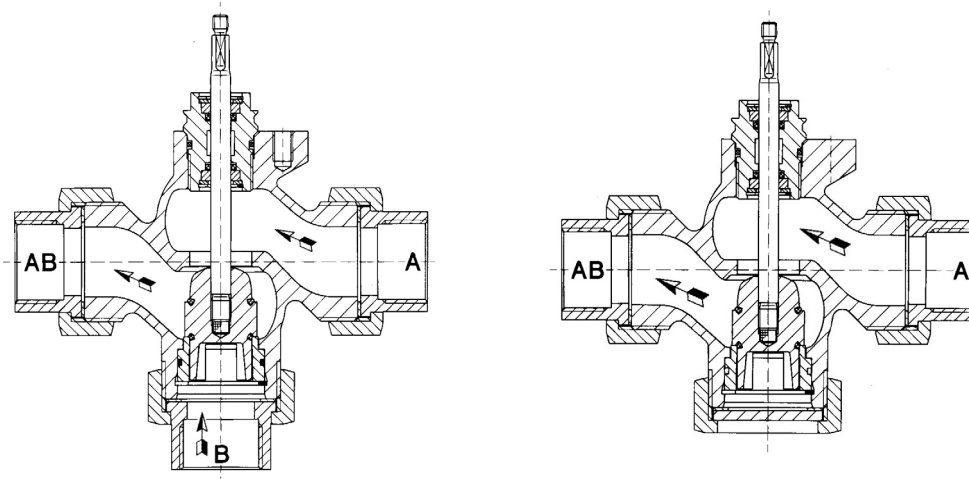

Overview of Compatible Valve Actuators

	MD50Y	MD200xx	MD210xx	MF200xx
RB15..50(-BF)	X	X	X	X
RB15..50T(-BF)	X	X	X	X



NOTE

You can find further information on using the valves with actuators in the product descriptions of the MD50Y, MD200xx, MD210xx and MF200xx actuators.

