

BCU070-L technolon® Switch Interface

Application

The technolon® switch interface binary controller for flush mounting, 7 BI/2 BO. Bus-capable switch interface with open communication using the LON Talk protocol for integration into any standard switching program. Suitable for accepting 7 potential-free contacts. Also, 2 binary switching outputs for feedback signals, suited for switching feedback LEDs or relays in compliance with workplace regulations.

Standard software application in accordance with LonMark profiles 3200 "Switch", 3250 "Scene Panel" and 3040 "Lamp Actuator". Interface module in a compact housing for mounting flush with the wall, in a cavity wall or in wall boxes behind any standard switch. Plug-in connection wires for simple installation.

Configuration using the user-friendly and standardized LNS3 plug-in in conjunction with an LNS3-based network management tool.

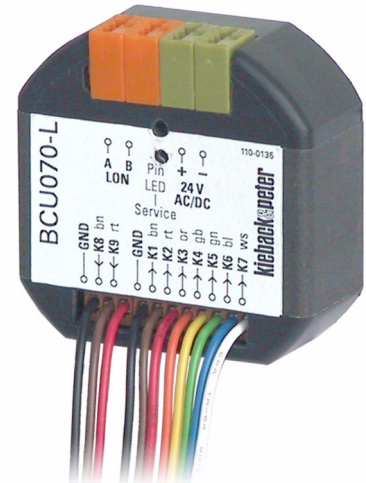

Contents	Page
Information about the device description	2
Safety instructions	2
Qualified technicians.....	2
Item.....	3
Technical data	3
Dimensions	3
Connection.....	4
Installation.....	5
Functional profile/network variables	6

Änderungen vorbehalten - Contents subject to change - Sous réserve de modifications - Reservado el derecho a modificación - Wijzigingen voorbehouden - Con riserva di modifichie - Innehåll som skall ändras - Změny vyhrazeny - Zmiany zastrzeżone - Возможны изменения - A változtatások jogát fenntartjuk - 保留未通知而改动的权力

Information about the device description

The description contains information about use and installation. If you have questions that are not covered by the device description, contact the supplier or manufacturer for further information.

The specified regulations/guidelines for mounting and installation are valid for the Federal Republic of Germany. If the device is used in other countries, local regulations are to be complied with at the personal responsibility of the system installer or operator.

Operating personnel are to be instructed according to the description of the technical data sheet.

Safety instructions

The valid work protection, accident prevention and VDE regulations are to be observed for installing and using the units.

Installation and set-up work on the units may only be carried out by qualified technicians. See section "Qualified technicians". Each person who uses the unit must have read and understood the descriptions in the technical data sheet.

Meanings of symbols in the technical data sheet:



DANGER!

Warning of electric voltage



WARNING!

General warning, note must be observed



Note!

Additional note to be observed

DANGER Means that non-observance could lead to life-threatening danger, serious bodily injury or major material damage.

CAUTION Means that non-observance could lead to an injury hazard to major material damage.

NOTE Means that the information requires special attention.

Qualified technicians

Qualified technicians in the context of the technical data sheet are persons who are familiar with the described devices and have the corresponding qualifications in their jobs.

This includes, for example:

- Authorization to connect the units in accordance with VDE regulations and the local energy supply company regulations, as well as authorization for switching on, off and enabling devices under observance of in-house regulations
- Knowledge of accident prevention regulations
- Knowledge of the use of devices within the system
- etc.

Item

BCU070-L technolon® switch interface

Technical data

Nominal voltage	AC 24 V; 2.9 VA / DC 24 V, 1.2 W
Inputs	7 binary inputs (BI) for potential-free contacts, 5 mA
Outputs	2 binary outputs (BO), DC 24 V, 20 mA
Bus connection	LON FTT10
Standards	LonMark functional profile 3200 "Switch", 3250 "Scene Panel", 3040 "Lamp Actuator"
Displays	1 service PIN LED, red
Degree of protection	IP20 (when built in)
Ambient temperature	0 to 45 °C
Ambient humidity	20 to 80% r. h., non-condensing
Dimensions	WxHxD mm 50x50x19
Weight	0.05 kg

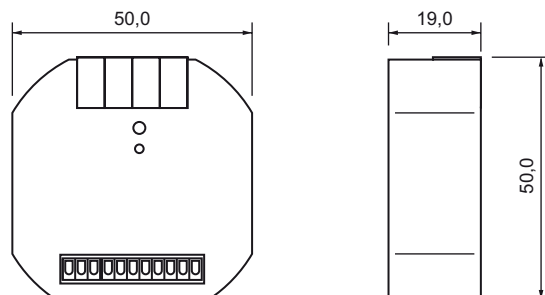
Dimensions

Device Description

BCU070-L technolon® Switch Interface

Connection

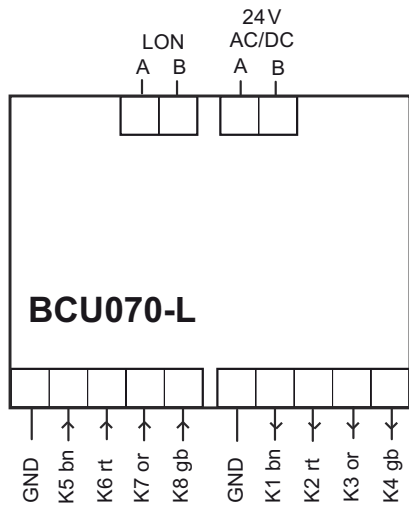

Example

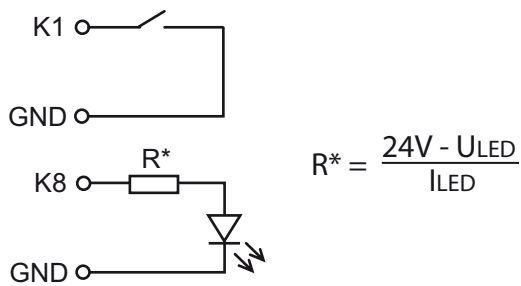
**WARNING!**

GND must not be connected to the supply voltage.

**Note!**

An R* series protective resistor is required to control the LED. This R* series protective resistor is integrated into most switch assemblies.

Installation



DANGER!

Mounting/demounting may only be carried out by qualified technicians when the voltage is switched off.



Note!

Deep flush-mount boxes (> 60 mm) are required when a switch and the BCU070-L are used together.

Recommendation for installation in cavity walls: Spelsberg HW 065 device connection box IP30, order no. 920 065 01

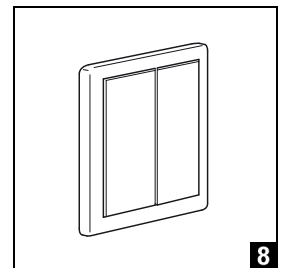
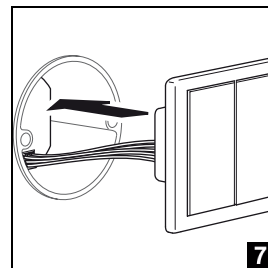
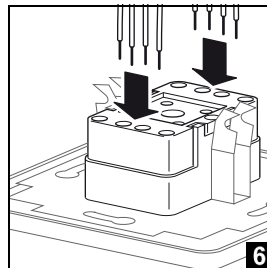
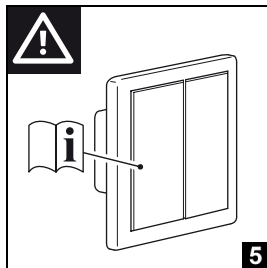
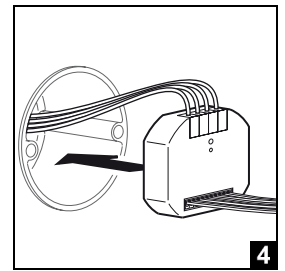
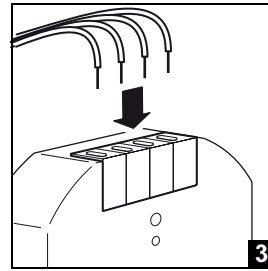
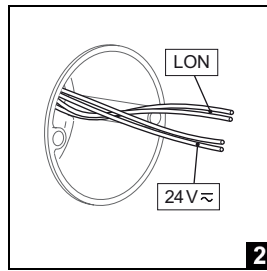
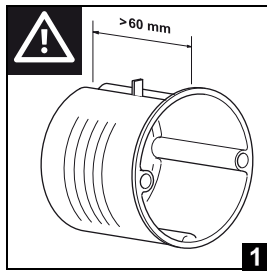

Functional profile/network variables

